

# PIPE CLAMP

one piece

 Type **115**  
**115 Gu**

Type 115

 Type 115 Gu  
 with elastomer inlay

 SOUND INSULATED  
 according to  
 DIN 4109

Material b x s	øD	L	d
20x1,5	21.3 22.0 26.9 consecutive pipe diameter until 50.0	20	6,5
20x2,0	42.0 42.4 44.5 consecutive pipe diameter until 630.0	20	6,5
30x2,5	50.0 51.0 54.0 consecutive pipe diameter until 1000.0	30	11,0
40x4,0	100.0 108.0 110.0 consecutive pipe diameter until 1000.0	35	14,0
<b>Other diameters on request.            Please tell us the requested            pipe diameter.</b>			

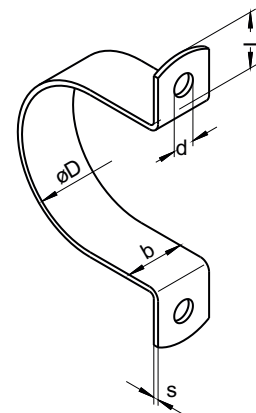

All dimensions in mm

### Description

Highly resilient, clean shaped, one piece pipe clamp made of zinc-coated band steel. The fastening serves for direct mounting on consoles, profil rails, walls or other. For usage with copper pipes the pipe clamp receives a glass fibre inlay. The glass fibre is resistant to constant temperatures up to 500°C. To corresponds to the requirements of sound protection the pipe clamp is delivered with an elastomer inlay on request.

### Preferable fields of application

Sanitary-, heating-, air- and climate technology

 Also STAINLESS available  
 RUST  
 PROOF